

BoxDrain Grates - Mesh

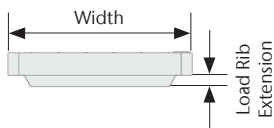
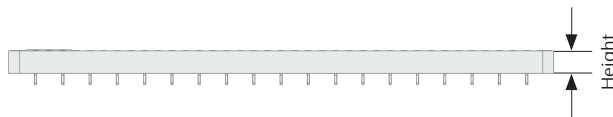
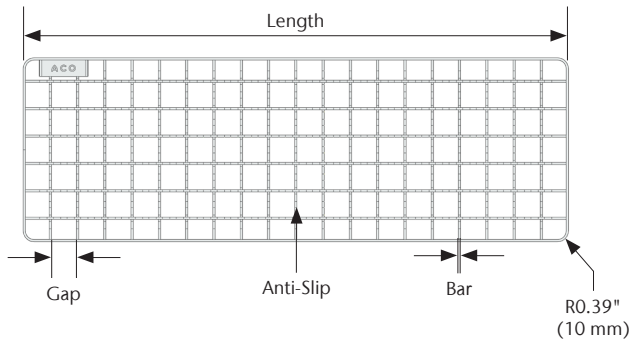
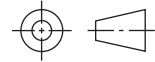

Specification Clause

ACO BoxDrain Mesh Grates. Used with ACO BoxDrain Channels. Made from AISI 304 or 316L grade stainless steel with electropolish finish. Load Class Per ASME A112.6.3. Certified to NSF/ANSI/3-a Standard 14159-1.

ACO recommends checking local plumbing codes prior to installation.

Parts	Part No.	Width in (mm)	Length in (mm)	Height in (mm)	Gap in (mm)	Bar in (mm)	Grate Material	Weight lbs.	EN1253 Load Class	ASME Load Class	Load Rib Support
Mesh Grate - BoxDrain 150	446296	4.65 (118)	19.69 (500)	0.79 (20)	0.91 (23)	0.08 (2)	AISI 304	3.1	L15	Light Duty	N
	446297	4.65 (118)	19.69 (500)	0.79 (20)	0.91 (23)	0.08 (2)	AISI 316L	3.1	L15	Light Duty	N
Mesh Grate - BoxDrain 200	416860	6.61 (168)	19.69 (500)	0.79 (20)	0.91 (23)	0.08 (2)	AISI 304	4.8	L15	Light Duty	Y
	416862	6.61 (168)	15.75 (400)	0.79 (20)	0.91 (23)	0.08 (2)	AISI 304	3.9	L15	Light Duty	Y
	416861	6.61 (168)	19.69 (500)	0.79 (20)	0.91 (23)	0.08 (2)	AISI 316L	4.8	L15	Light Duty	Y
	416863	6.61 (168)	15.75 (400)	0.79 (20)	0.91 (23)	0.08 (2)	AISI 316L	3.9	L15	Light Duty	Y
Mesh Grate - BoxDrain 300	416866	10.55 (268)	19.69 (500)	0.79 (20)	0.91 (23)	0.08 (2)	AISI 304	7.4	L15	Light Duty	Y
	416864	10.55 (268)	11.81 (300)	0.79 (20)	0.91 (23)	0.08 (2)	AISI 304	4.5	L15	Light Duty	Y
	416867	10.55 (268)	19.69 (500)	0.79 (20)	0.91 (23)	0.08 (2)	AISI 316L	7.4	L15	Light Duty	Y
	416865	10.55 (268)	11.81 (300)	0.79 (20)	0.91 (23)	0.08 (2)	AISI 316L	4.5	L15	Light Duty	Y
Mesh Grate - BoxDrain 400	416870	14.49 (368)	23.62 (600)	1.18 (30)	0.91 (23)	0.08 (2)	AISI 304	13.0	L15	Light Duty	N
	416856	14.49 (368)	19.69 (500)	1.18 (30)	0.91 (23)	0.08 (2)	AISI 304	10.9	L15	Light Duty	N
	416868	14.49 (368)	15.75 (400)	1.18 (30)	0.91 (23)	0.08 (2)	AISI 304	8.8	L15	Light Duty	N
	416871	14.49 (368)	23.62 (600)	1.18 (30)	0.91 (23)	0.08 (2)	AISI 316L	13.0	L15	Light Duty	N
	416857	14.49 (368)	19.69 (500)	1.18 (30)	0.91 (23)	0.08 (2)	AISI 316L	10.9	L15	Light Duty	N
	416869	14.49 (368)	15.75 (400)	1.18 (30)	0.91 (23)	0.08 (2)	AISI 316L	8.8	L15	Light Duty	N
Mesh Grate - BoxDrain 500	416872	18.43 (468)	19.69 (500)	1.18 (30)	0.91 (23)	0.08 (2)	AISI 304	13.6	L15	Light Duty	N
	416874	18.43 (468)	15.75 (400)	1.18 (30)	0.91 (23)	0.08 (2)	AISI 304	11.0	L15	Light Duty	N
	416873	18.43 (468)	19.69 (500)	1.18 (30)	0.91 (23)	0.08 (2)	AISI 316L	13.6	L15	Light Duty	N
Mesh Grate - BoxDrain 600	416875	18.43 (468)	15.75 (400)	1.18 (30)	0.91 (23)	0.08 (2)	AISI 316L	11.0	L15	Light Duty	N
	416876	22.36 (568)	11.81 (300)	1.18 (30)	0.91 (23)	0.08 (2)	AISI 304	10.1	L15	Light Duty	N
Mesh Grate - BoxDrain 800	416877	22.36 (568)	11.81 (300)	1.18 (30)	0.91 (23)	0.08 (2)	AISI 316L	10.1	L15	Light Duty	N
	416878	30.24 (768)	15.75 (400)	1.18 (30)	0.87 (22)	0.12 (3)	AISI 304	26.0	L15	Light Duty	N
	416879	30.24 (768)	15.75 (400)	1.18 (30)	0.87 (22)	0.12 (3)	AISI 316L	26.0	L15	Light Duty	N

ACO, Inc.

West Sales Office
825 W. Beechcraft Street
Casa Grande, AZ 85122
Tel: (520) 421-9988
Toll-Free: (888) 490-9552
Fax: (520) 421-9899

Northeast Sales Office
9470 Pinecone Drive
Mentor, OH 44060
Tel: (440) 639-7230
Toll-Free: (800) 543-4764
Fax: (440) 639-7235

Southeast Sales Office
481 Munn Road
Suite 225
Fort Mill, SC 29715
Toll-Free: (800) 543-4764
Fax: (803) 802-1063

info@acousa.com
www.acousa.com

© March 2023 ACO, Inc.

All reasonable care has been taken in compiling the information in this document. All recommendations and suggestions on the use of ACO products are made without guarantee since the conditions of use are beyond the control of the company. It is the customer's responsibility to ensure that each product is fit for its intended purpose and that the actual conditions of use are suitable. ACO, Inc. reserves the right to change products and specifications without notice.

ACO. we care for water

