

BoxDrain Grates - Frameless Ladder

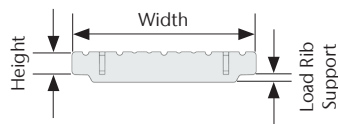
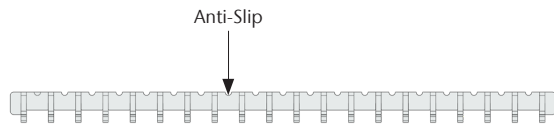
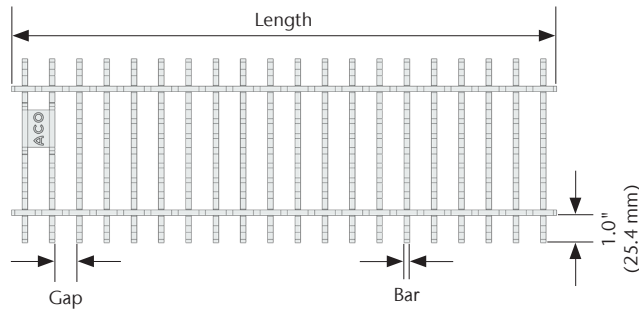
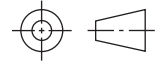

Specification Clause

ACO BoxDrain Frameless Ladder Grates. Used with ACO BoxDrain Channels. Made from AISI 304 or 316L grade stainless steel with electropolish finish. Fully welded steel with electropolish finish. Fully drainable, inspectable and cleanable. Frameless Ladder Grate is designed for superior hygienic performance. Slip-resistant. Load Class Per ASME A112.6.3. Certified to NSF/ANSI/3-a Standard 14159-1.

ACO recommends checking local plumbing codes prior to installation.

ACO Specification Information

Parts	Part No.	Width in (mm)	Length in (mm)	Height in (mm)	Gap in (mm)	Bar in (mm)	Grate Material	Weight lbs.	EN1253 Load Class	ASME Load Class	Load Rib Support
Frameless Grate - BoxDrain 150	446290	4.65 (118)	19.69 (500)	0.79 (20)	0.79 (20)	0.16 (4)	AISI 304	4.8	R50	Light Duty	Y
	446292	4.65 (118)	19.69 (500)	0.79 (20)	0.79 (20)	0.20 (5)	AISI 304	6.2	M125	Medium Duty	Y
	446291	4.65 (118)	19.69 (500)	0.79 (20)	0.79 (20)	0.16 (4)	AISI 316L	4.8	R50	Light Duty	Y
	446293	4.65 (118)	19.69 (500)	0.79 (20)	0.79 (20)	0.20 (5)	AISI 316L	6.2	M125	Medium Duty	Y
Frameless Grate - BoxDrain 200	446246	6.61 (168)	19.69 (500)	0.79 (20)	0.79 (20)	0.16 (4)	AISI 304	6.5	R50	Light Duty	Y
	446250	6.61 (168)	15.75 (400)	0.79 (20)	0.79 (20)	0.16 (4)	AISI 304	5.2	R50	Light Duty	Y
	446248	6.61 (168)	19.69 (500)	0.79 (20)	0.79 (20)	0.20 (5)	AISI 304	8.5	M125	Medium Duty	Y
	446252	6.61 (168)	15.75 (400)	0.79 (20)	0.79 (20)	0.20 (5)	AISI 304	6.8	M125	Medium Duty	Y
	446247	6.61 (168)	19.69 (500)	0.79 (20)	0.79 (20)	0.16 (4)	AISI 316L	6.5	R50	Light Duty	Y
	446251	6.61 (168)	15.75 (400)	0.79 (20)	0.79 (20)	0.16 (4)	AISI 316L	5.2	R50	Light Duty	Y
	446249	6.61 (168)	19.69 (500)	0.79 (20)	0.79 (20)	0.20 (5)	AISI 316L	8.5	M125	Medium Duty	Y
Frameless Grate - BoxDrain 300	446253	6.61 (168)	15.75 (400)	0.79 (20)	0.79 (20)	0.20 (5)	AISI 316L	6.8	M125	Medium Duty	Y
	446254	10.55 (268)	19.69 (500)	0.79 (20)	0.79 (20)	0.16 (4)	AISI 304	9.6	R50	Light Duty	Y
	446258	10.55 (268)	11.81 (300)	0.79 (20)	0.79 (20)	0.16 (4)	AISI 304	5.9	R50	Light Duty	Y
	446256	10.55 (268)	19.69 (500)	0.79 (20)	0.79 (20)	0.20 (5)	AISI 304	14.3	M125	Medium Duty	Y
	446260	10.55 (268)	11.81 (300)	0.79 (20)	0.79 (20)	0.20 (5)	AISI 304	8.7	M125	Medium Duty	Y
	446255	10.55 (268)	19.69 (500)	0.79 (20)	0.79 (20)	0.16 (4)	AISI 316L	9.6	R50	Light Duty	Y
	446259	10.55 (268)	11.81 (300)	0.79 (20)	0.79 (20)	0.16 (4)	AISI 316L	5.9	R50	Light Duty	Y
	446257	10.55 (268)	19.69 (500)	0.79 (20)	0.79 (20)	0.20 (5)	AISI 316L	14.3	M125	Medium Duty	Y
	446261	10.55 (268)	11.81 (300)	0.79 (20)	0.79 (20)	0.20 (5)	AISI 316L	8.7	M125	Medium Duty	Y

ACO, Inc.

West Sales Office
 825 W. Beechcraft Street
 Casa Grande, AZ 85122
 Tel: (520) 421-9988
 Toll-Free: (888) 490-9552
 Fax: (520) 421-9899

Northeast Sales Office
 9470 Pinecone Drive
 Mentor, OH 44060
 Tel: (440) 639-7230
 Toll-Free: (800) 543-4764
 Fax: (440) 639-7235

Southeast Sales Office
 481 Munn Road
 Suite 225
 Fort Mill, SC 29715
 Toll-Free: (800) 543-4764
 Fax: (803) 802-1063

info@acousa.com
 www.acousa.com

© March 2023 ACO, Inc.

All reasonable care has been taken in compiling the information in this document. All recommendations and suggestions on the use of ACO products are made without guarantee since the conditions of use are beyond the control of the company. It is the customer's responsibility to ensure that each product is fit for its intended purpose and that the actual conditions of use are suitable. ACO, Inc. reserves the right to change products and specifications without notice.

ACO. we care for water

